

MOD: XC114

EXPLODED VIEW DISEGNO ESPLOSO

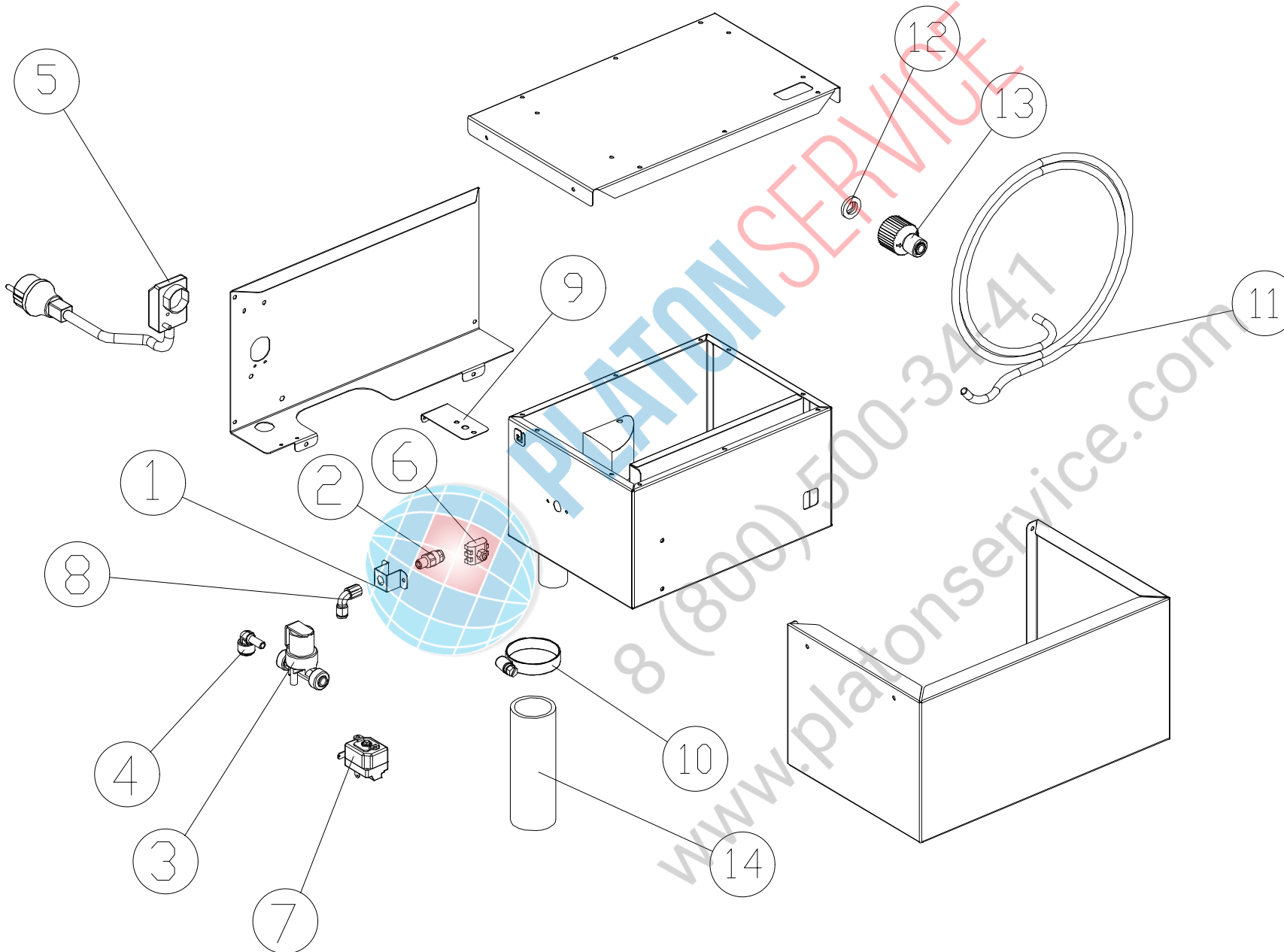

LEGEND - LEGENDA

1	OH2425B0
2	BRI205A0
3	EL1310A0
4	EL1195A0
5	CE116
6	VM250
7	TRI070A0
8	RC1285A0
9	OH3075A0
10	RC1055A0
11	TB008
12	RC1210A0
13	GN1200A0
14	TB1520A0

DESCRIZIONE CODICI

1	OH2425B0	STAFFETTA SUPPORTO UGELLO INOX
2	BR1205A0	UGELLO CONDENSATORE CAPP A OTTONE XC314/535/595
3	EL1310A0	ELETTROVALVOLA H2O 1 VIA NO RID. JG IN Ø8-OUT Ø8 230V 50
4	EL1195A0	RACCORDO A GOMITO CON J.GUEST CODOLO D8 - D8
5	CE116	CAVO 3x1,5 H07RN-F MT1,5+K1/3+SCHUK
6	VM250	MORSETT A PETTINE
7	TR1070A0	TERMOSTATO 50°C CONTATTO A SCAMBIO
8	RC1285A0	RACCORDO A GOMITO CON CODOLO D=8-D=1/8GAS FEMMIN
9	OH3075A0	STAFFA INOX TERMOSTATO XC114
10	RC1055A0	FASCETTA STRINGI TUBO METALLICA INOX Ø25-40 H=12
11	TB008	TUBO PE 7,93x4,75 TRASPARENTE
12	RC1210A0	RACCORDO 3/4 FEMM. - J.GUEST Ø8 CON FILTRO E VNR
13	GN1200A0	GUARNIZIONE D=24 RACCORDO 3/4 GOMMA+RETE
14	TB1520A0	TUBO D.Int=30 SP=4 GOMMA EPDM NERO

DESCRIPTION

1	OH2425B0	STAINLESS STEEL NOZZLE SUPPORT
2	BR1205A0	
3	EL1310A0	WATER SOLENOID VALVE 1 WAY NO REDUCER JG INØ8-OUTØ8 2
4	EL1195A0	ELBOW UNION WITH J.GUEST TERMINAL D8 - D8
5	CE116	EL CABLE 3x1.5 H07RN-F MT1,5+K1/3+SCHUKO
6	VM250	"COMB" TERMINAL BOARD
7	TR1070A0	
8	RC1285A0	
9	OH3075A0	
10	RC1055A0	STAINLESS STEEL CLIP TO TIGHT PIPES Ø25-40 H=12
11	TB008	TRANSPARENT TUBE PE 7,93x4,75
12	RC1210A0	3/4 FEMALE CONNECTION - J. GUEST Ø8 WITH FILTER AND VNR
13	GN1200A0	SEAL D=24 CONNECTION 3/4 RUBBER+NET
14	TB1520A0	BLACK EPDM RUBBER PIPE D.Int=38 TH=4



PLATON SERVICE
8 (800) 500-34-41
www.platonservice.com